



■ Features:

- Universal AC input/ Full range
- High Efficiency, and High reliability
- Output protections: SCP/OVP/OPP/OLP
- Wide operating ambient temperature (-20°C ~70°C)
- All using 105°C long life electrolytic capacitors.
- 100% full load burn-in test
- 2 years warranty

SPECIFICATION

MODEL		PD-25-S3.3	PD-25-S5	PD-25-S12	PD-25-S15	PD-25-S24	
OUTPUT	DC Output	3.3V	5V	12V	15V	24V	
	Rated Current	6A	5A	2.1A	1.7 A	1.1A	
	Current Range	Note 1	0~6A	0~5A	0~2.1A	0~1.7A	0~1.1A
	Ripple and Noise	0~70°C	80mV	80mV	120mV	120mV	120mV
		Note 2 -20~0°C					240 mV
	Voltage ADJ. Range	±10% of rated output voltage					
	Voltage Accuracy	±2.0%	±2.0%	±1.0%	±1.0%	±1.0%	
	Line Regulation	±0.5%	±0.5%	±0.5%	±0.5%	±0.5%	
	Load Regulation	±2.0%	±2.0%	±1.0%	±1.0%	±1.0%	
	Set-up Time	<2.0S (120Vac input, Full load); <1.0S (230Vac input, Full load)					
	Hold up Time	>14mS(120Vac input, Full load); >30mS(230Vac input, Full load)					
	Temperature Coefficient	±0.03%/°C					
	Overshoot and Undershoot	<5.0%					
INPUT	Voltage Range	88Vac~264Vac					
	Frequency Range	47Hz~63Hz					
	Efficiency (Typical)	70%(120Vacinput	75%(120Vacinput	80%(120Vacinput	81%(120Vacinput)	83%(120Vacinput	
		71%(230Vacinput	77%(230Vacinput	82%(230Vacinput	83%(230Vacinput)	84%(230Vacinput	
	AC Current (max.)	0.7A	0.7A	0.35A	0.7A	0.7A	
	Inrush Current (Typical)	20A@120Vac	40A@230Vac	Cold start			
Leakage Current	Input—output:<0.25mA		Input—PG:<0.75mA				
PROTECTION	Over Power	105%-150% of rated output current, hiccup mode,Constant power					
	Over Current	105%-150% of rated output current, hiccup mode,Constant current					
	Over Voltage	105%-150% of rated output voltage, Constant Voltage ,re-power on to recover					
	Shorted Circuit	Long-term mode, auto recovery					
ENVIRONMENT	Operating amb. Temp. & Hum.	-20°C~70°C; 20%~90%RH No condensing((refer to the derating curve)					
	Storage Temp. & Hum.	-40°C~85°C; 10%~95%RH No condensing					
SAFETY & EMC Note 3	Safety Standards	UL60950-1; EN60950-1; 2006					
	Withstand Voltage	Primary-Secondary:3.0KVac; ≤10mA .Primary-PG:1.5KVac; ≤10mA. Secondary-PG:0.5KVDC;≤10mA.					
	Isolation Resistance	≥100M ohms					
	EMI Conduction&Radiation	Compliance to EN55022(CISPR22) ClassB					
	Harmonic Current	Compliance to EN61000-3-2,-3					
EMS Immunity	Compliance to EN61000-4-2,3,4,5,6,8,11;ENV50204,light industry level,criteriaA						
OTHERS	MTBF (MIL-HDBK-217F)	More than 100,000Hrs (25°C, Full load)					
	Dimension (L*W*H)	93×51×28mm					
	Packing	48PCS/CTN, G.W:10.4kgs					
	Cooling method	Cooling by free air convection					
NOTE	<ol style="list-style-type: none"> 1. All parameters NOT specially mentioned are measured at rated input, rated load and 25°C of ambient temperature. 2. Measured at 20MHz of bandwidth by using a 12" twisted pair-wire terminated with a 0.1 uF & 47uF parallel capacitor. 3. The SPS is considered a component which will be installed into final equipment. The equipment must be re-confirmed that it still meets EMC directives. 						

■ Mechanical Specification

Unit: mm

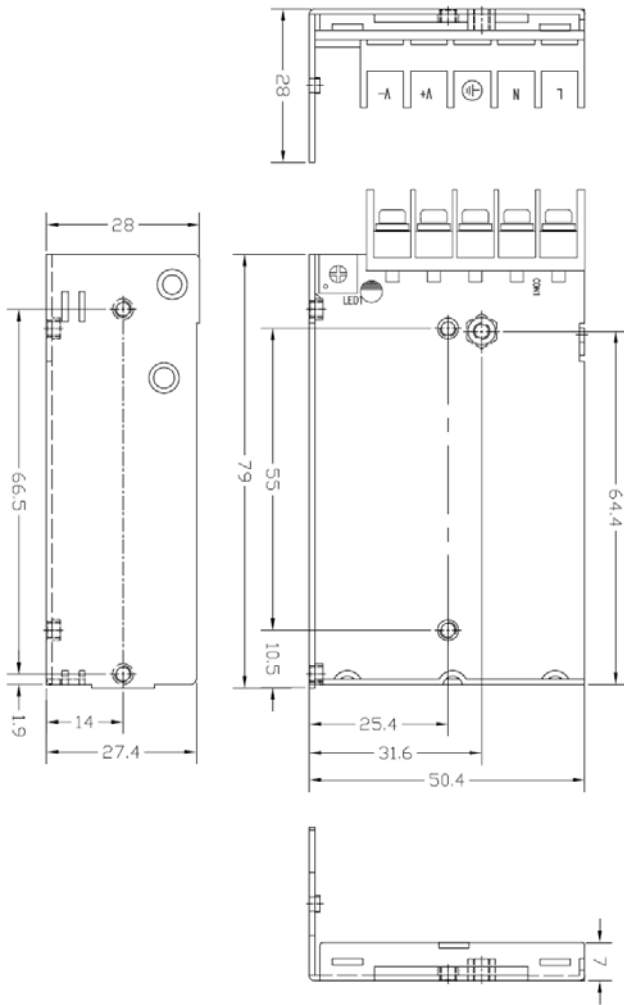

Pin No.	Assignment
1	AC-L
2	AC-N
3	F.G
4	DC output -V
5	DC output +V

■ Block Diagram

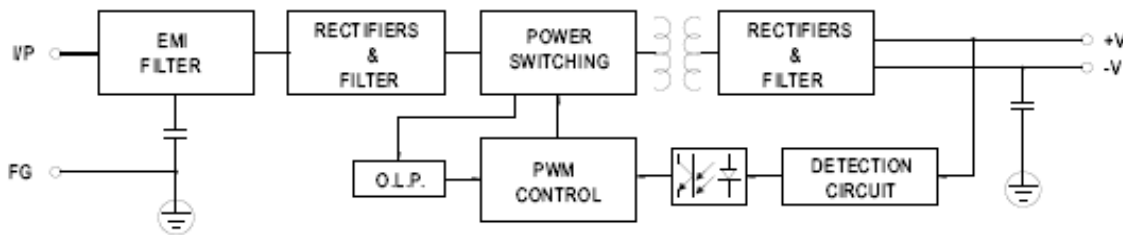

■ Derating Curve

